

# Always one cut ahead.

## intelliDivide

The optimization software for panel dividing on saws and nesting machines.

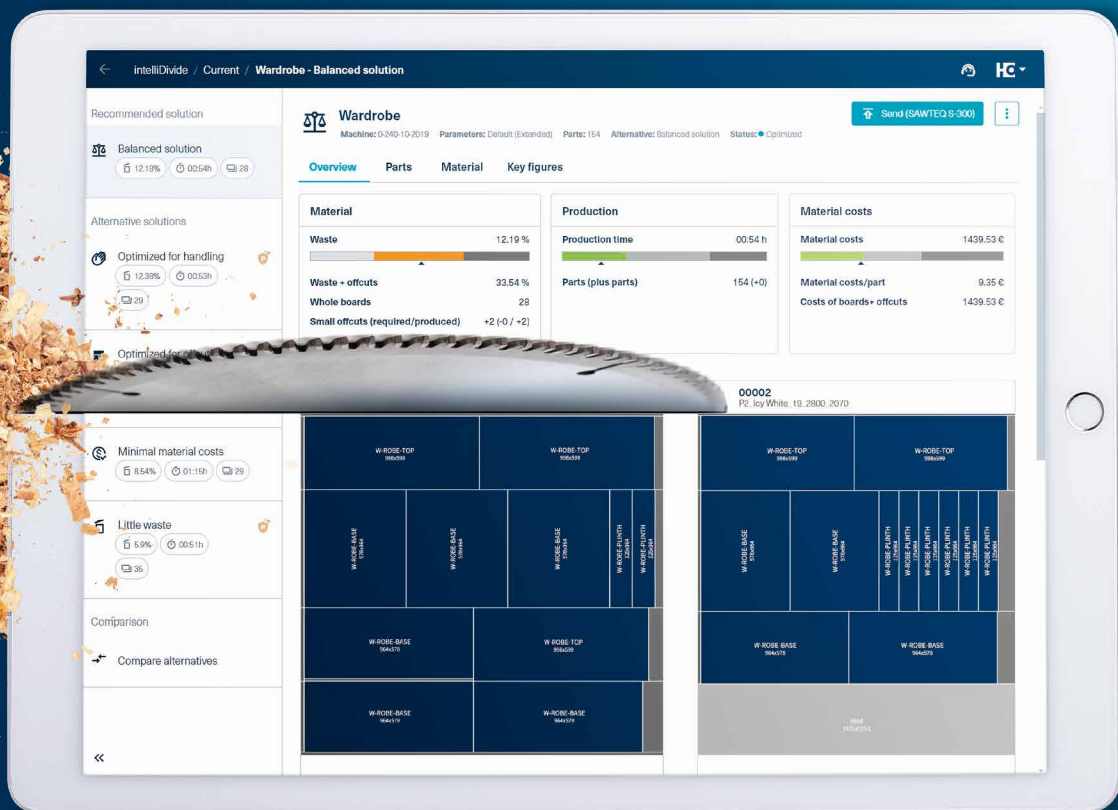

**My laptop doesn't just update me with the daily news, it also provides me with optimized cutting patterns.**





# intelliDivide – The optimization software for panel dividing on saws and nesting machines

It's a known fact among carpenters that creating cutting and nesting patterns manually causes additional hours in work preparation that could be used in other ways. Everyone wants to minimize the time required and achieve efficient results. That's exactly what intelliDivide offers – the optimization software for panel dividing. intelliDivide makes your work easy: conveniently upload a parts list and begin the optimization with a single click. Cutting patterns are calculated automatically and immediately, without any manual intermediate steps or time-consuming settings to be made. And all without having to invest in software and computing power, because intelliDivide is a web-based app that runs in the cloud.

## YOUR SOLUTION

### CONTENTS

- 04 What is special about intelliDivide?
- 05 Creating an optimization
- 06 The functions of a cutting optimization
- 10 Using the results
- 12 Interaction with the HOMAG apps
- 14 Possible applications
- 16 Interfaces and automation
- 17 Licensing | Technical data
- 18 Apps and digital assistants



More information at  
[digital.homag.com](https://digital.homag.com)

# What is special about intelliDivide?

With many optimization solutions on the market, the operator has to configure numerous settings and perform manual intermediate steps when working with the software until the desired result is achieved: from the installation of the software and setting of the machine and optimization parameters through to post-optimization.

## INTELLIDIVIDE TAKES CARE OF ALL OF THIS FOR YOU!

- ✓ **Simple start – log in and get started. No installation necessary!**
- ✓ **Adoption of machine settings**
- ✓ **Post-optimization and variant settings**
- ✓ **Re-sorting of the strips**
- ✓ **Comparison of results**
- ✓ **Proposal of the best solution**
- ✓ **Direct transfer of results to the machine**
- ✓ **Archiving and deletion of processed jobs**

## Your benefits at a glance

### MORE TIME FOR OTHER TASKS

intelliDivide optimizes the cutting patterns for you. This makes manual calculation a thing of the past.

### OPTIMIZATION BASED ON THE DAY'S OBJECTIVES

intelliDivide always calculates multiple alternatives for you to select, based on waste, short machine running time, easy handling, lowest material costs and much more.

### PRODUCTION DATA AT THE TOUCH OF A BUTTON

intelliDivide generates data for panel storage, cutting, nesting and labeling.

### MATERIAL MANAGEMENT INCLUDED

intelliDivide provides the central management of material types and panel sizes for your optimization free of charge.

### NESTING PATTERNS FOR THE CNC

intelliDivide also optimizes nesting patterns for your CNC machine. One software interface for two panel dividing technologies!

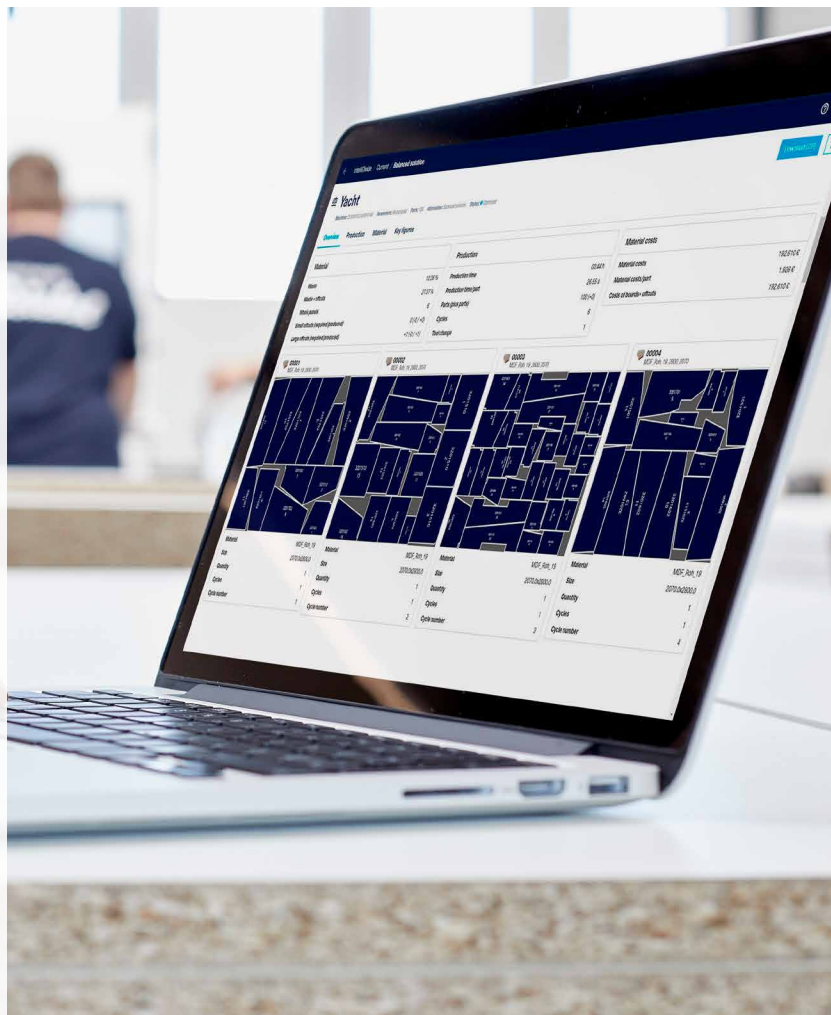

# The five highlights

- 1 EASY TO USE**  
 Very easy to get started thanks to intuitive and clear operation

---

- 2 SOFTWARE AS A SERVICE**  
 Transparent and fair costs, always up to date, regardless of the number of users or the end device

---

- 3 OPTIMAL RESULTS**  
 Several optimization algorithms simultaneously calculate a large number of variants

---

- 4 MULTIPLE SOLUTIONS**  
 Simultaneous calculation of several alternative solutions with selection option

---

- 5 INTELLIGENTLY NETWORKED**  
 Optimal interaction with the HOMAG apps for perfectly networked digital production

## Creating an optimization

It's that easy!

Length (mm)	Width (mm)	Material code
504.2	198.7	P2_Gold Craft Oak_19
504.2	389.7	P2_Gold Craft Oak_19
504.2	389.7	P2_Gold Craft Oak_19
504.2	198.7	P2_Gold Craft Oak_19
1088.7	398.7	P2_Lichtgrau_19
1088.7	398.7	P2_Lichtgrau_19
598.7	518.7	P2_Lichtgrau_19
598.7	518.7	P2_Lichtgrau_19
375.0	375.0	P2_Weiss_08



- Balanced solution**  
 18.81% 03:14h 51
- Minimal material costs**  
 9.26% 05:35h 51
- Little waste**  
 10.23% 04:32h 51
- Optimized for handling**  
 52.67% 05:35h 51



1 Import of the parts list or the CNC programs

2 Optimization of cutting patterns in intelliDivide

3 Selection of the preferred solution for the current job

4 Cutting and label printing on the machine

# In a nutshell:

## The functions of a cutting optimization

### Creating or importing parts lists

The most important part of creating a cutting optimization is the parts list. There are several options available to you so that you can work with your parts list in intelliDivide:

- **Manual entry** of the parts list directly into intelliDivide
- **Import** from a text file or Excel list, including CNC programs for nesting
- **Sending** directly to intelliDivide via HOMAG productionManager
- **Sending** via a cloud interface (API interface) from CAD/CAM and ERP systems
- **Automatic import** with the HOMAG File Agent (see p. 16). The optimization can also be started automatically (optional).

Position / Anteil	Material code	Description	Length (mm)	Width (mm)	Grain	Template	Quantity	Kundenantrag	Edge front
1	P2_GoldCrafft Oak_19	Drawer Front	594,2	198,7	Lengthwise		1	Gardenöde Ecke 1+1	ABS, Ecke: 1,3-2,5 JHM
1	P2_GoldCrafft Oak_19	Drawer Front	594,2	389,7	Lengthwise		1	Gardenöde Ecke 1+1	ABS, Ecke: 1,3-2,5 JHM
1	P2_GoldCrafft Oak_19	Drawer Front	594,2	389,7	Lengthwise		1	Gardenöde Ecke 1+1	ABS, Ecke: 1,3-2,5 JHM
1	P2_GoldCrafft Oak_19	Drawer Front	594,2	198,7	Lengthwise		1	Gardenöde Ecke 1+1	ABS, Ecke: 1,3-2,5 JHM
2	P2_Lichtgrau_19	Vertical Panel	1198,7	398,7	None		1	Gardenöde Ecke 1+1	123, Achtelgrau, 1,90_43...
3	P2_Lichtgrau_19	Vertical Panel	1198,7	398,7	None		1	Gardenöde Ecke 1+1	123, Achtelgrau, 1,90_43...
1	P2_Lichtgrau_19	Vertical Panel	598,7	518,7	None		1	Gardenöde Ecke 1+1	123, Achtelgrau, 1,90_43...
1	P2_Lichtgrau_19	Vertical Panel	598,7	518,7	None		1	Gardenöde Ecke 1+1	123, Achtelgrau, 1,90_43...
2	P2_Weiss_09	Backband	1170,0	370,0	None		1	Gardenöde Ecke 1+1	
1	P2_Weiss_09	Backband	1170,0	1170,0	None		1	Gardenöde Ecke 1+1	
1	P2_Weiss_19	Cover Panel	1198,7	398,7	None		1	Gardenöde Ecke 1+1	ABS, Weiss, 2,25_14M
2	P2_Weiss_19	Overlay Door	1198,7	398,7	None		1	Gardenöde Ecke 1+1	ABS, Weiss, 2,25_14M
1	P2_Weiss_19	Vertical Panel	592,0	500,0	None		1	Gardenöde Ecke 1+1	ABS, Weiss, 2,25_14M
1	P2_Weiss_19	Horizontal Panel	571,6	500,0	None		1	Gardenöde Ecke 1+1	ABS, Weiss, 2,25_14M
1	P2_Weiss_19	Horizontal Panel	571,6	500,0	None		1	Gardenöde Ecke 1+1	ABS, Weiss, 2,25_14M
2	P2_Weiss_19	Horizontal Panel	362,0	398,7	None		1	Gardenöde Ecke 1+1	ABS, Weiss, 2,25_14M
1	P2_Weiss_19	Horizontal Panel	1182,0	518,7	None		1	Gardenöde Ecke 1+1	ABS, Weiss, 2,25_14M

### Managing panel data

In addition to the parts list, intelliDivide requires information about the panel materials that are to be used for cutting. You can use various options to manage your panels:

- **Direct access** to the panel data in HOMAG materialManager. This central material management system provides the material types and – in conjunction with the materialAssist Boards app – also the material stocks and is directly linked to intelliDivide.
- **Drop-down list selection:** Even if the information about which panel material is required is usually transferred directly with the parts list, material can easily be added or changed later.

**Result:** intelliDivide sorts the material and creates separate cutting patterns for each material type.

Material code	Board code	Length (mm)	Width (mm)	Thickness (mm)	Grain	Costs (€ / m²)	Type	Available
MOF_2142_19_190	MOF_2142_19_190_2000x2070	2000,0	2070,0	19,0	Lengthwise		Inventory	9999
MOF_2142_19_190	MOF_2142_19_190_2000x2070	2000,0	2070,0	19,0	Lengthwise		Inventory	9999
MOF_2142_19_190	MOF_2142_19_190_2000x2070	2000,0	2070,0	19,0	Lengthwise		Inventory	9999
P2_GoldCrafft Oak_19	P2_GoldCrafft Oak_19_2000x2070	2000,0	2070,0	19,0	Lengthwise	12,8	Inventory	19
P2_GoldCrafft Oak_19	P2_GoldCrafft Oak_19_2000x2070	2000,0	2070,0	19,0	Lengthwise	12,8	Offset	0
P2_GoldCrafft Oak_19	P2_GoldCrafft Oak_19_2000x2070	2000,0	2070,0	19,0	Lengthwise	12,8	Offset	1
P2_Lichtgrau_19	P2_Lichtgrau_19_2000x2070	2000,0	2070,0	19,0	None	8,2	Inventory	9999
P2_Lichtgrau_19	P2_Lichtgrau_19_2000x2070	2000,0	2070,0	19,0	None	8,2	Offset	1
P2_Weiss_09	P2_Weiss_09_2000x2070	2000,0	2070,0	8,0	None	5	Inventory	9999
P2_Weiss_19	P2_Weiss_19_2000x2070	2000,0	2070,0	19,0	None	9	Inventory	8
P2_Weiss_19	P2_Weiss_19_1000x1000	1000,0	1000,0	19,0	None	9	Offset	0
P2_Weiss_19	P2_Weiss_19_800x1800	800,0	1800,0	19,0	None	9	Offset	1
Spiegelglas 19_1, Schmelz	Spiegelglas 19mm_Schmelz_2000_2070	2000,0	2070,0	19,0	None	6,5	Inventory	9999
Spiegelglas 19_1, Schmelz	Spiegelglas 19mm_Schmelz_3000_3000	3000,0	3000,0	19,0	None	6,5	Offset	2
Spiegelglas 19_1, Schmelz	Spiegelglas 19mm_Schmelz_1000x1000	1000,0	1000,0	19,0	None	6,5	Offset	0
Spiegelglas 19_1, Schmelz	Spiegelglas 19mm_Schmelz_999x999	999,0	999,0	19,0	None	6,5	Offset	2

**00002**  
P2\_Weiss\_19\_2000x2070

Material: P2\_Weiss\_19  
Size: 2000.0x2070.0  
Quantity: 1  
Cycle: 1  
Cycle number: 2

**00003**  
P2\_Lichtgrau\_19\_2000x2070

Material: P2\_Lichtgrau\_19  
Size: 2200.0x2070.0  
Quantity: 1  
Cycle: 1  
Cycle number: 3

**00001**  
P2\_GoldCrafft Oak\_19\_770.6x2070.0

Material: P2\_GoldCrafft Oak\_19  
Size: 770.6x2070.0  
Quantity: 1  
Cycle: 1  
Cycle number: 1

## Reusing panel offcuts

When managing your panels, you can also record existing or resulting offcuts after cutting and make them available for the next optimization:

- **Define individually: What is an offcut?** In intelliDivide, you can define the dimensions from which a waste part is marked as an offcut and therefore reused.
- **Optional: Connection to woodStore storage software.** If you use a HOMAG storage system with the woodStore software, the panel data can be imported using materialManager, the central material management system from HOMAG. In this case, woodStore is the leading system. Offcuts created on the saw are automatically created in woodStore and are therefore also available in materialManager and in intelliDivide for the next optimization.

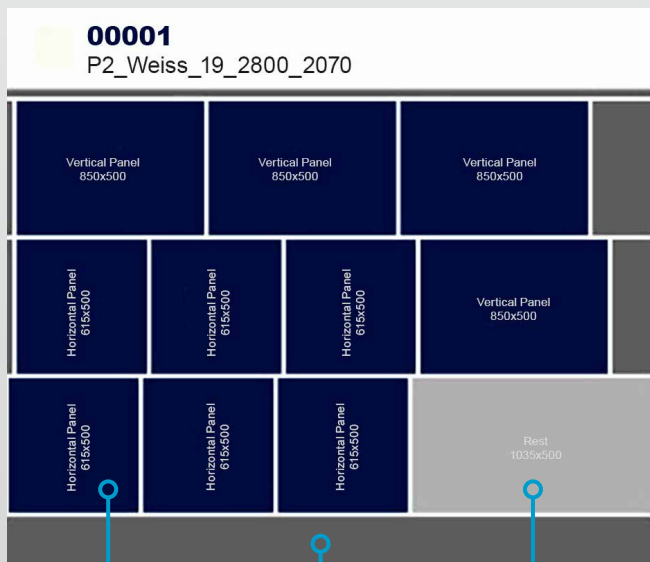

Components

Waste

Offcut

## Using templates (for saws)

To intentionally keep components together and perform cutting in a specified arrangement (e.g. with a continuous veneer pattern for furniture fronts), you can use templates in intelliDivide:

- **Selection from the template library:** A library with a wide range of templates is available directly in the software. The components within the template are assigned directly in the parts list.
- **Individual templates:** New templates can be created easily – according to current requirements.

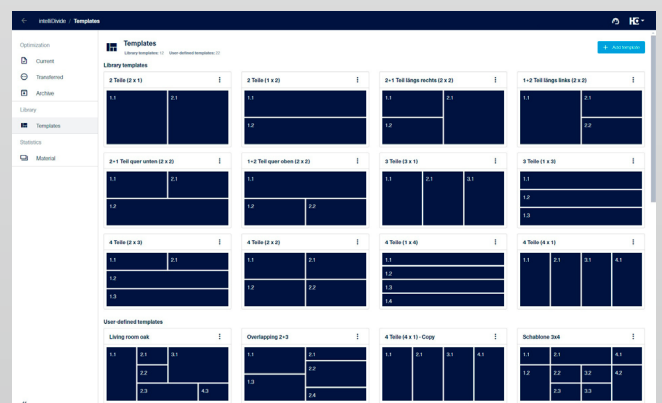
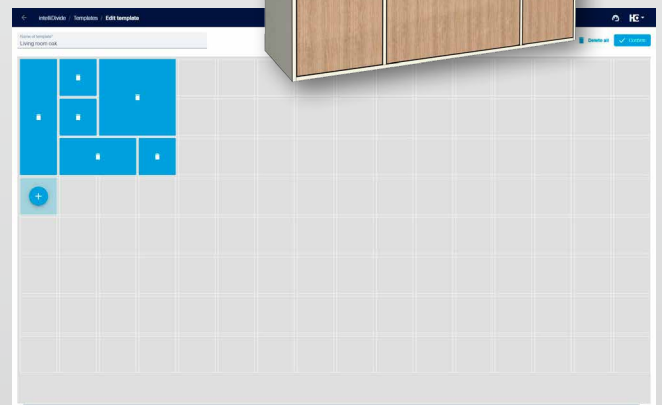
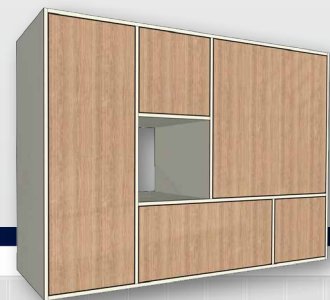

## In a nutshell:

# The functions of a cutting optimization

### For saws: Machine parameters

Most of the parameters are automatically adopted from your saw or from HOMAG machine templates. Important parameters can also be set individually:

- Cutting length and program fence travel
- Saw blade thickness
- Setting for offcut sizes
- Evaluation of the offcuts in % of the material value
- Trims and stress relief cuts (tension trims)

**Machine parameters** [Close]

**In general** | Offcuts | Trim cut | Tension trim

Name: 0-240-73-6138 SAWTEQ B-320 flexTec | Type: HPS300

Apply machine settings

**Saw blade kerf**  
Saw blade kerf: 4.4 mm

[More information](#) |

### For saws: Material-dependent parameters

Some parameters can be set on a material-specific basis. To do this, you can create material groups and set the following properties individually in **materialManager** (central material management from HOMAG):

- Offcut sizes
- Package height
- Trims
- Stress elimination cuts

In intelliDivide, the operator decides whether to use the general machine parameters or the material-specific settings.

**Machine parameters** [Close]

In general | Offcuts | **Trim cut** | Tension trim

**Minimal trim**  
Trim cut: 15.0 mm

**Minimal trim for recut**  
In front: 8.0 mm | Behind: 8.0 mm

**Override rip and crosscut trims**  
 Undershoot trim

*The above dimensions include the saw blade.*

[More information](#) |



# SAW



## For CNC machines: Optimization parameters for nesting

**When dividing panels in the nesting process, intelliDivide is different in some aspects from the saw version:**

- Workpieces created with the HOMAG CNC programming system woodWOP are used for nesting.
- intelliDivide calculates both rectangular and free-formed geometries.
- For components with large cut-outs, additional parts can be placed in the cut-out (part-in-part nesting).
- For better utilization of the protection board, the "extended computing time" option can be used to calculate similar nesting patterns.

**All important settings can be configured in intelliDivide and saved and reused under various profiles:**

- Parts clearance
- Rotation angle
- Do not place small parts on the edge
- Calculate similar nests (extended computing time)

**Additional nesting functions are available in conjunction with the woodWOP nesting plugin (from woodWOP 8):**

- "Stay down" (repositioning without retraction) and "Common line" (common trimming track)
- Trimming in steps
- Positioning bars (from woodWOP 8.1)

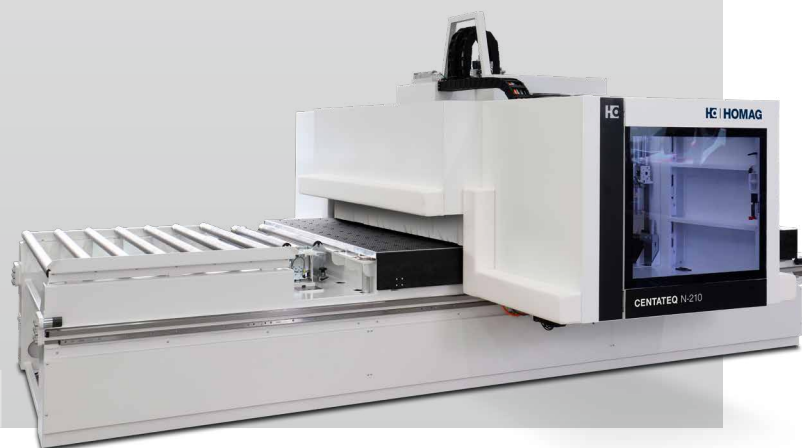
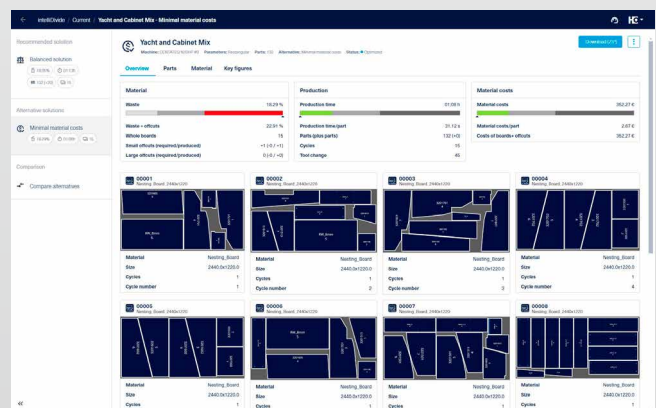
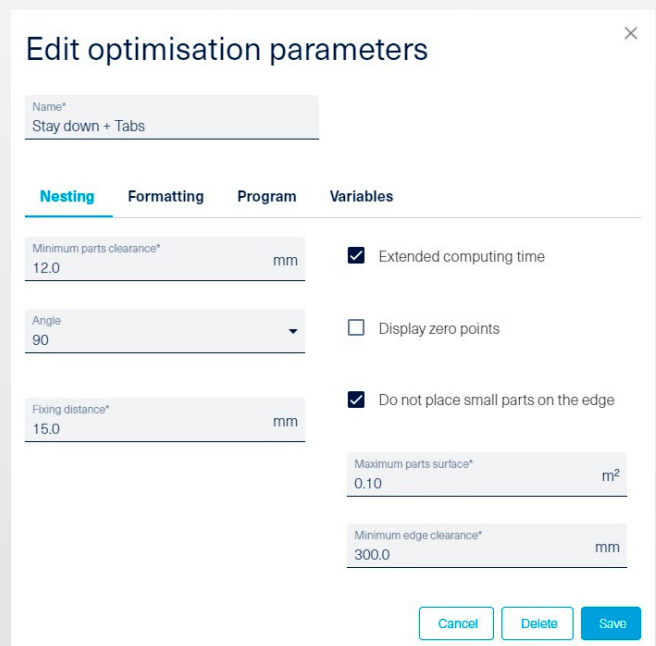

NESTING

# Using the results

## Cutting patterns and alternative solutions

### Alternative solutions

**Low waste + offcuts**

12.19% 04:12h 51

**Optimized for offcuts**

21.13% 03:27h 51

**Little waste**

10.23% 04:32h 51

**Minimal material costs**

9.26% 05:35h 51

**Optimized for handling**

52.67% 05:35h 51

**Comparison**

Compare alternatives

**intelliDivide - Dining Room-01 - Balanced solution**

Recommended solution: Balanced solution (18.81% / 03:14h / 51)

**Alternative solutions:**

- Low waste + offcuts (12.19% / 04:12h / 51)
- Optimized for offcuts (21.13% / 03:27h / 51)
- Little waste (10.23% / 04:32h / 51)
- Minimal material costs (9.26% / 05:35h / 51)
- Optimized for handling (52.67% / 05:35h / 51)

**Comparison:** Compare alternatives

**Overview:** Parts, Material, Key figures

Material	Waste	Production time	Material costs
	18.82%	03:14 h	2555.91 €
Waste + offcuts	27.20%	18:07 s	3.98 €
Whole boards	\$1	Parts (+plus parts)	645 (+0)
Small offcuts (required/produced)	0 (0) / -0	Cycles	22
Large offcuts (required/produced)	-28 (0) / +28	Average book height	34.6 mm

**Material costs:** 2555.91 €

**Material costs/part:** 3.98 €

**Costs of boards + offcuts:** 2555.91 €

**00001:** P2\_White\_08\_2800\_2070

**00002:** P2\_White\_08\_2800\_2070

**00003:** P2\_Joy White\_19\_2800\_2070

**00004 M:** VP\_2816\_12\_1250\_2050

**Material:** VP\_2816\_12

**Size:** 1250x2050.0

**Quantity:** 1

**Cycles:** 20

**Cycle number:** 20

### For saws: intelliDivide Cutting

intelliDivide Cutting simultaneously calculates several solutions for the saw and makes them available for selection – e.g. optimized based on waste, short machine running time, easy handling, lowest material costs and much more.

- Select the right solution for your current application and transfer it directly to the saw as a SAW file.
- If you are not using a HOMAG saw, a PTX file is available for download. Many saws from other machine manufacturers on the market can import this format.

### For CNC nesting machines: intelliDivide Nesting

During nesting, intelliDivide calculates alternative solutions, primarily when using plus parts (e.g. if you want to pre-produce parts in a specific material that do not belong to the current job).

- Select the right solution for your current application, download the associated MPR(X) file and save it in the working folder of the CNC machine.

## Comparing alternatives

The "Compare alternatives" function displays all results in a table.

- Green key figure: This solution provides the best result compared to the others.
- Red key figure: The solution has the worst value compared to the others.

	Balanced solution	Optimized for offcuts	Minimal material costs	Optimized for handling	Minimum waste
<b>Material</b>					
Waste	11.40 %	21.13 %	9.63 %	38.30 %	8.52 %
Waste + offcuts	32.98 %	37.19 %	32.98 %	66.39 %	34.34 %
Whole boards	61	61	61	62	62
Small offcuts (required/produced)	+13 (-0) / +13	+10 (-0) / +10	+17 (-0) / +17	+17 (-0) / +17	+15 (-0) / +15
Large offcuts (required/produced)	+20 (-0) / +20	+12 (-0) / +12	+17 (-0) / +17	+22 (-0) / +22	+23 (-0) / +23
<b>Production</b>					
Production time	02:56 h	02:27 h	04:47 h	05:10 h	06:33 h
Production time/part	16.34 s	19.24 s	26.73 s	28.8 s	36.57 s
Parts (plus parts)	645 (+0)	645 (+0)	645 (+0)	645 (+0)	645 (+0)
Cycles	19	24	40	43	49
Average book height	40.1 mm	31.8 mm	19.1 mm	18.2 mm	15.9 mm
Presence at the machine	01:55 h	02:30 h	01:59 h	01:13 h	02:28 h
<b>Material costs</b>					
Material costs	2562.51 €	2628.93 €	2504.27 €	2559.42 €	2538.62 €
Material costs/part	3.97 €	4.07 €	3.88 €	3.96 €	3.93 €
Costs of boards+ offcuts	2562.51 €	2628.93 €	2504.27 €	2559.42 €	2538.62 €

## Calculating panel and edge requirements

intelliDivide calculates the total material requirement and displays it in the material overview:

- Required panels
- Required offcuts and generated offcuts
- Required edge material
- Storage location of the panels and edges

In addition, the entire cutting pattern overview – including the material overview – can be downloaded as a PDF document.

Material code	Board code	Type	Length (mm)	Width (mm)	Thickness (mm)	Demand
PF_Guid Craft_Dat_19	PF_Guid Craft_Dat_19	Inventory	2900.0	2070.0	19.0	1
PF_Waste_08	PF_Waste_08_2890_20	Inventory	2900.0	2070.0	8.0	1
PF_Waste_19	PF_Waste_19_2890_20	Inventory	2900.0	2070.0	19.0	2

Material code	Length (mm)	Width (mm)	Quantity
PF_Guid Craft_Dat_19	982.4	973.7	1
PF_Waste_08	2070.0	807.6	1
PF_Waste_19	807.2	190.0	1
PF_Waste_19	2070.0	1615.4	1

Edge code	Height (mm)	Thickness (mm)	Demand (m)
ABE_34Nm_1.3_21_H5M	230	1.30	11.78
PP_Waste_1.3_22_H5M	220	1.30	24.24

## Using material efficiently

intelliDivide provides you with an overview of the material usage of the optimizations transferred over the past year using various diagrams. Use this valuable information to analyze and improve your material usage:

- Most frequently used materials
- Increase/decrease in offcuts
- Material usage: How many panels/offcuts were used and how many parts, offcuts or waste parts were created?

**Objective:** Increase the efficiency and sustainability of panel material during cutting.





# intelliDivide

## Interaction with the HOMAG apps

With intelliDivide, you create a building block to make your production process more digital step by step. You can use the optimization solution as stand-alone software and then expand it on a modular basis with additional apps from the HOMAG portfolio if required. All applications communicate seamlessly with each other, so you can gradually make your data flow consistent.

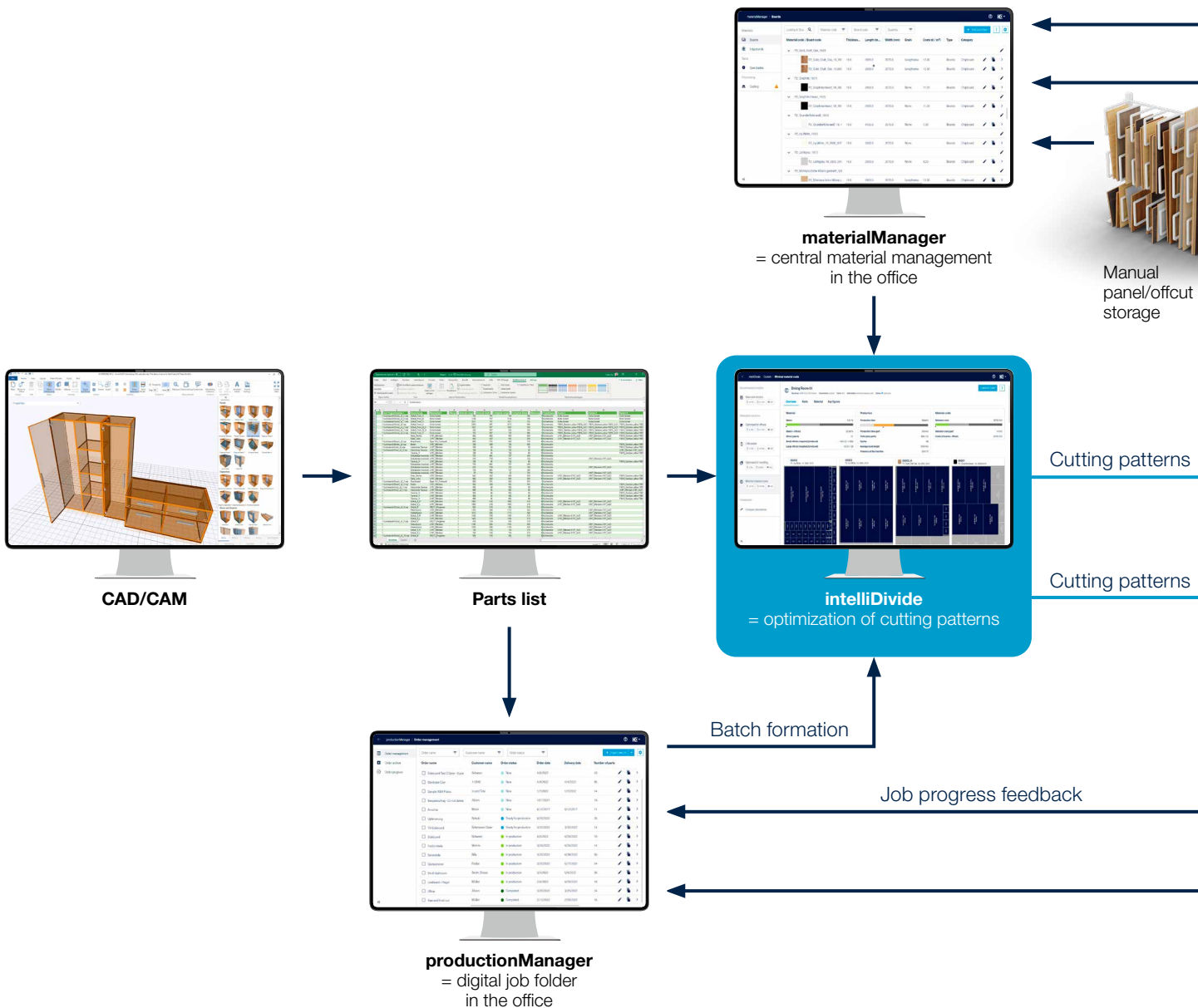

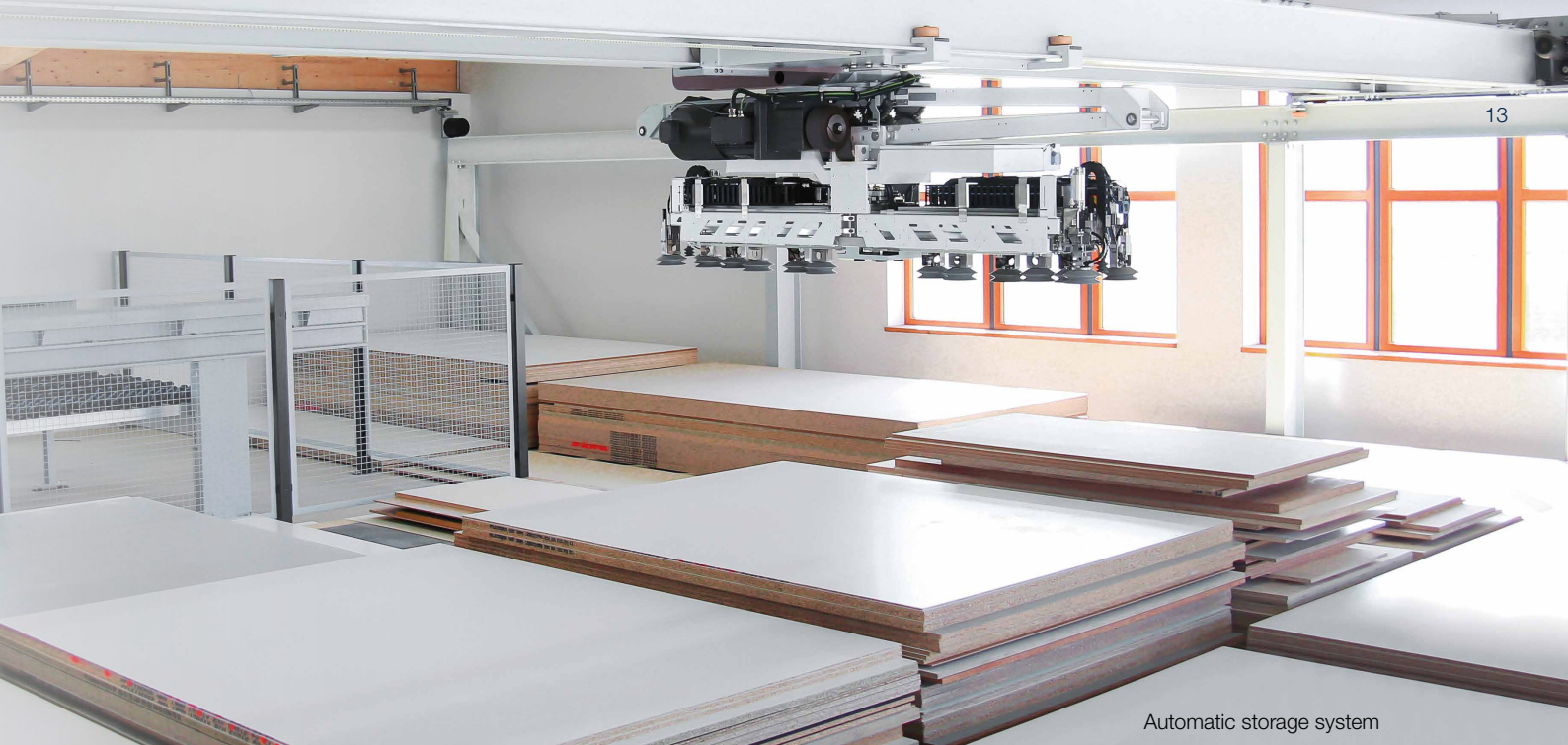

Automatic storage system

Comparison of data



Material	Length	Width	Thickness	Quality	Color	Assignment	Area
1000x1000	1000	1000	18	Standard	White	1000	1000
1000x1000	1000	1000	18	Standard	White	1000	1000
1000x1000	1000	1000	18	Standard	White	1000	1000
1000x1000	1000	1000	18	Standard	White	1000	1000
1000x1000	1000	1000	18	Standard	White	1000	1000
1000x1000	1000	1000	18	Standard	White	1000	1000
1000x1000	1000	1000	18	Standard	White	1000	1000
1000x1000	1000	1000	18	Standard	White	1000	1000
1000x1000	1000	1000	18	Standard	White	1000	1000
1000x1000	1000	1000	18	Standard	White	1000	1000

**materialAssist Boards**  
= app for material management in the workshop

Consumption/offcuts



**woodStore**  
= storage control system

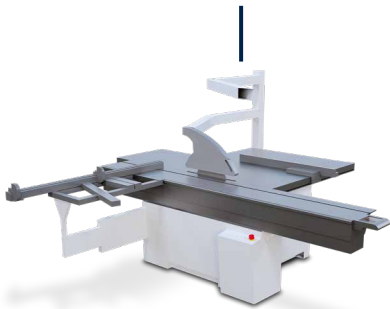

Job progress feedback

Material	Length	Width	Thickness	Quality	Color	Assignment	Area
1000x1000	1000	1000	18	Standard	White	1000	1000
1000x1000	1000	1000	18	Standard	White	1000	1000
1000x1000	1000	1000	18	Standard	White	1000	1000
1000x1000	1000	1000	18	Standard	White	1000	1000
1000x1000	1000	1000	18	Standard	White	1000	1000
1000x1000	1000	1000	18	Standard	White	1000	1000
1000x1000	1000	1000	18	Standard	White	1000	1000
1000x1000	1000	1000	18	Standard	White	1000	1000
1000x1000	1000	1000	18	Standard	White	1000	1000
1000x1000	1000	1000	18	Standard	White	1000	1000

**productionAssist Feedback**  
= app for feedback on processing in the workshop

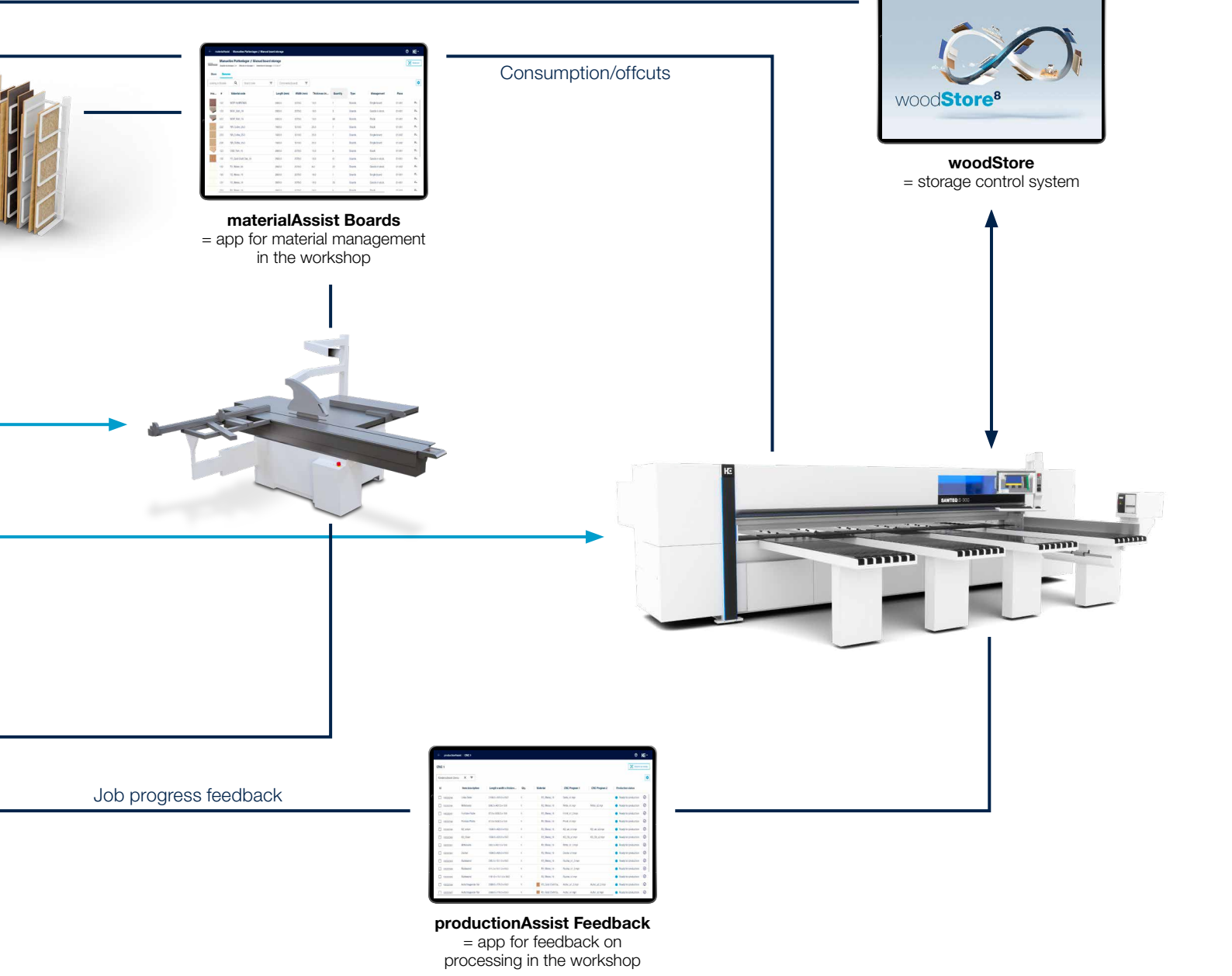



# intelliDivide grows with you

## Solutions for dividing panel material



### Cutting Production Set

- Our cutting assistant supports you in optimizing your cutting patterns with intelliDivide, in the cutting process and in labeling the parts at your manual saw.
- Optimize your cutting patterns simply by clicking and transferring them to the app on your tablet in the workshop. There, you can work through the cutting pattern using a clear overview in the app – and print an individual label for each part.

### Panel dividing saw

- intelliDivide automatically adopts all the essential settings of the HOMAG panel dividing saw.
- You can start optimizing cutting patterns in intelliDivide with just a few clicks.
- You can transfer the cutting patterns of your choice directly from the software to the saw.
- For third-party machines, the cutting patterns can be downloaded in PTX format.



### Nesting CNC

- Ideal nesting solution for HOMAG CNC machines: intelliDivide calculates patterns for rectangular parts as well as for free-formed parts.
- Additional nesting functions are available in conjunction with the woodWOP 8 nesting plugin: "Stay down" (repositioning without retraction), "Common line" (common trimming track) and "Positioning bars."
- Our nesting assistant (Nesting Production Set) helps you to quickly and easily label components after nesting.

### Saw/nesting combined with storage

- The woodStore storage control software is used in a storage system.
- intelliDivide uses the HOMAG materialManager (central material management) as a board library.
- Thanks to a suitable interface, the panels and offcuts that you manage in woodStore are available directly in materialManager and in intelliDivide.
- Changes that you make in woodStore are synchronized in materialManager.

# Complete networking

## Interfaces and automation

### HOMAG File Agent

#### Automated data exchange between intelliDivide and work preparation

- The HOMAG File Agent is software that HOMAG provides free of charge if your machine only offers limited or no connectivity, or if no coordinated interface to your software is available in work preparation.
- With the HOMAG File Agent, you can easily import parts lists. If desired, the data exchange between work preparation/machine and intelliDivide can also be started automatically for optimization.
- The HOMAG File Agent monitors configured network drives or local directories and automatically processes the files stored in them.

### API interface

#### The remote control of intelliDivide

- This interface enables customers or external software companies to commission intelliDivide as a web service via a REST API and to retrieve results.
- An authorization key is required to access the API.
- The following CAD/CAM and ERP systems already offer the interface to intelliDivide: Borm, imos iX, SmartCabinet, SmartWOP, SWOOD.

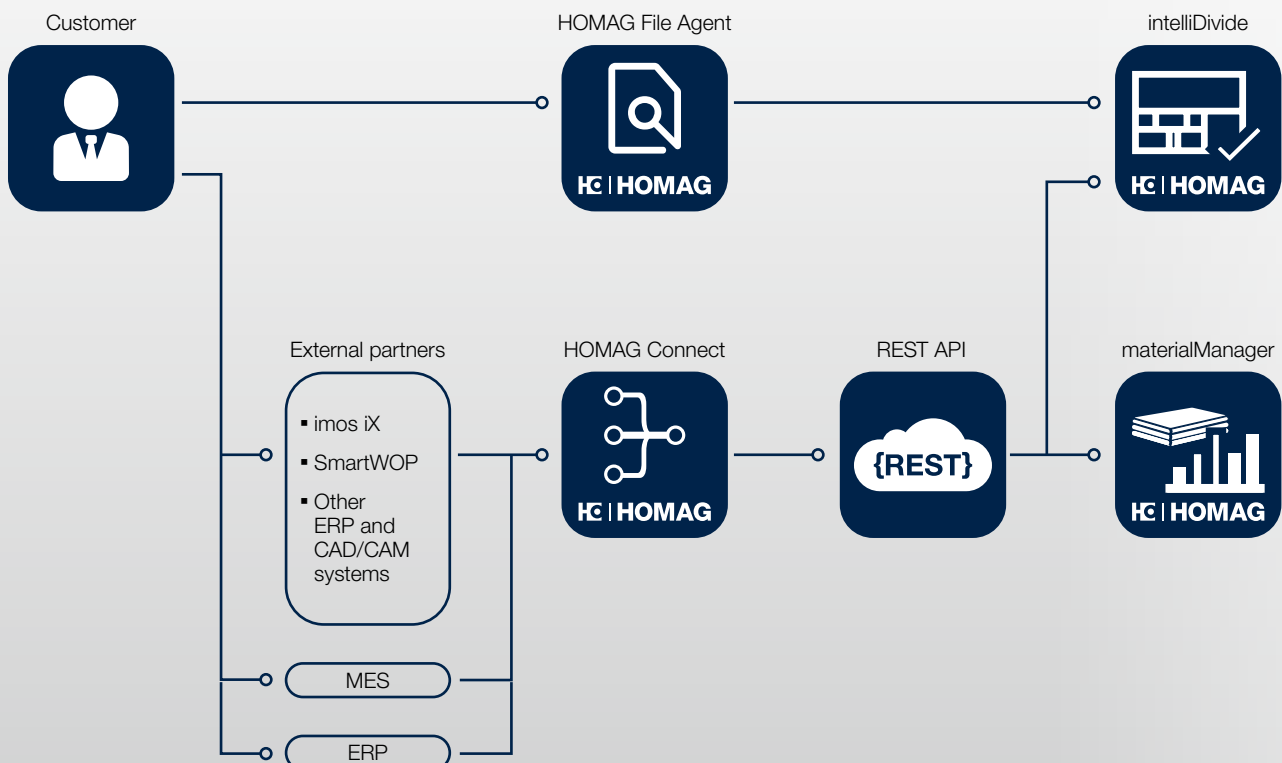



# Licensing

You purchase a company license for intelliDivide.  
 This means that you only book the app once and can add as many users as you like.

	intelliDivide Cutting Classic	intelliDivide Cutting Advanced	intelliDivide Cutting Premium	intelliDivide Nesting Classic	intelliDivide Nesting Advanced
Number of components per month	2,500*	10,000*	100,000*	2,500*	10,000*
Number of standard fields for parts list	12	12	12	12	12
Number of additional fields for further information	21 (fixed)	99 (individual)	99 (individual)	21 (fixed)	99 (individual)
Additional functions included	<b>Included in the Cutting Production Set</b> <ul style="list-style-type: none"> <li>intelliDivide Cutting Classic</li> <li>materialManager</li> <li>materialAssist Boards</li> <li>productionAssist Cutting</li> </ul>	<ul style="list-style-type: none"> <li>API interface</li> <li>Material statistics</li> <li>Material-dependent parameters</li> </ul>	<ul style="list-style-type: none"> <li>API interface</li> <li>Twice as many alternatives thanks to extended computing time</li> <li>Optimization based on time</li> <li>Material statistics</li> <li>Material-dependent parameters</li> </ul>	<b>Included in the Nesting Production Set</b> <ul style="list-style-type: none"> <li>intelliDivide Nesting Classic</li> <li>materialManager</li> <li>materialAssist Boards</li> <li>productionAssist Nesting</li> </ul>	<ul style="list-style-type: none"> <li>API interface</li> <li>Similar nesting patterns due to extended computing time</li> <li>Material statistics</li> </ul>

\*Additional parts packages can be easily booked in the tapio shop retrospectively.

# Technical data

You can use intelliDivide directly in the Internet browser on any number of PCs or laptops. This means you do not have to waste time and effort installing software. What's more, it means that the application is always automatically up to date.

Use	Web app/browser application for use on a PC or laptop. HOMAG saws are supported from version CADmatic 3.
Browser	We recommend: Microsoft Edge, Google Chrome or Apple Safari
Internet access (DSL, UTMS, LTE)	At least 5 Mbit/recommended 50 Mbit
Logging in	Via tapio login (tapio account required) Registration at: <a href="http://www.tapio.one">www.tapio.one</a>



Book intelliDivide in the tapio shop: [store.tapio.one](http://store.tapio.one)



intelliDivide is available in these countries!



Video series "Digital overview with intelliDivide Cutting"

# Apps and digital assistants

## Quick and easy support in your machine environment.

Some people still use pen and paper to create their cutting patterns. But they look at their smartphone if they want to know what the weather is like – instead of looking out of the window. We asked ourselves: why not combine the best of both? Our apps and digital solutions make your everyday work easier: machines, material, tools, cutting patterns, components – you always have everything in your pocket or on your desk.

### EXCERPTS FROM YOUR FEEDBACK:

- Are there simple solutions that can eliminate various obstacles in my day-to-day work (e.g. when organizing materials or sorting parts)?
- Is there a way to slowly approach using digital assistants?
- Which tools can you try out simply and easily without having to invest huge sums of money straight away?

### OUR ANSWER? SMART AND POWERFUL SOLUTIONS:

- ✓ Always low investment
- ✓ Always up to date (no updates necessary)
- ✓ Always easy to use (no complex software)
- ✓ Always helpful

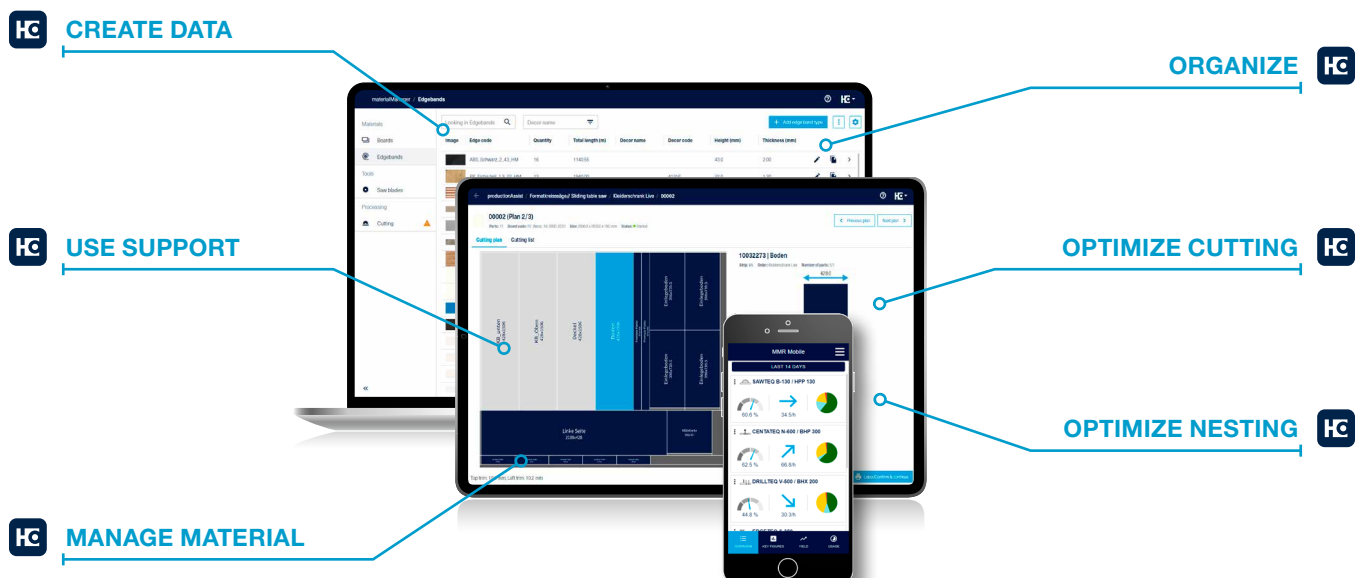

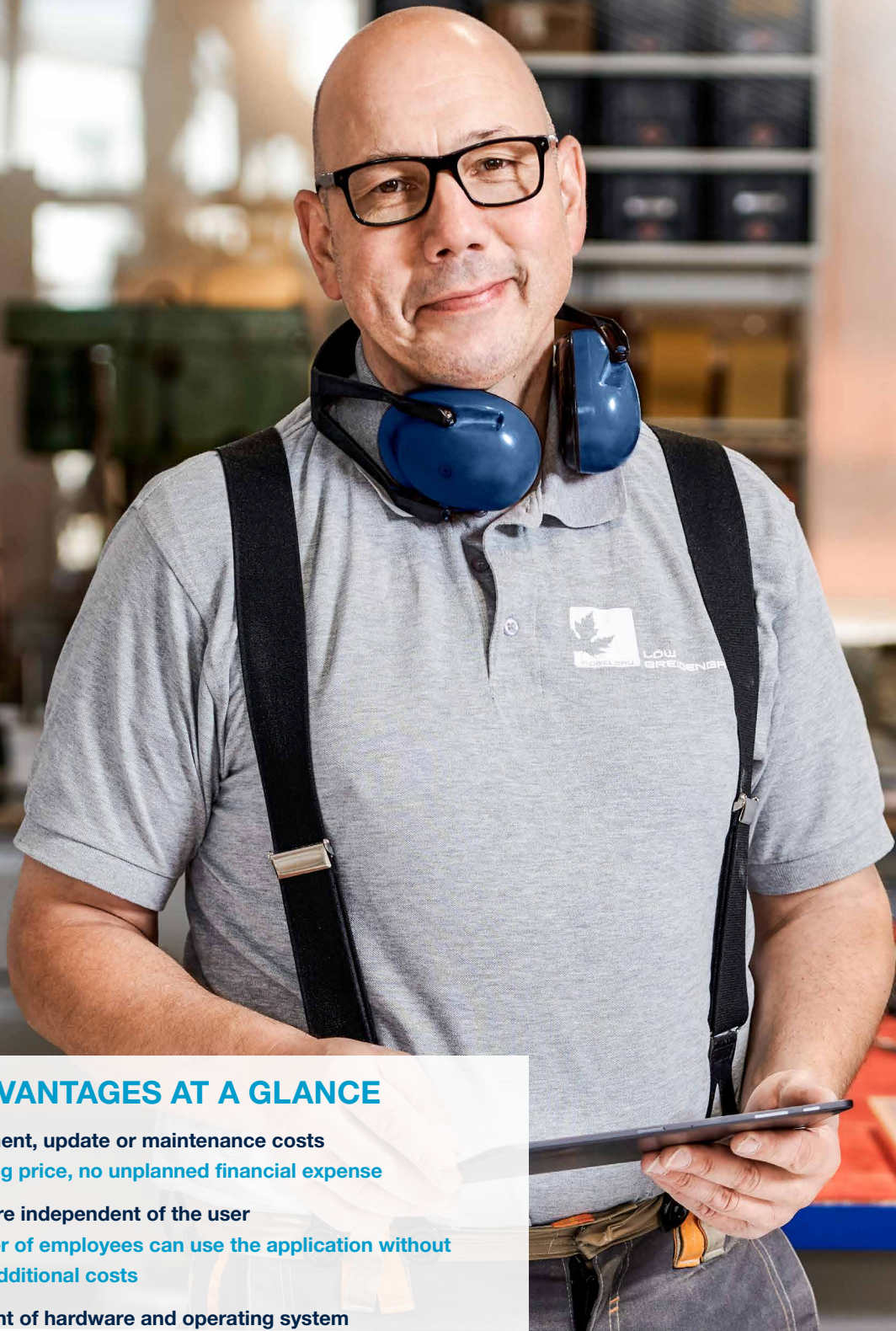

## THE ADVANTAGES AT A GLANCE

- No investment, update or maintenance costs  
Low starting price, no unplanned financial expense
- Licenses are independent of the user  
Any number of employees can use the application without incurring additional costs
- Independent of hardware and operating system  
Can be used anywhere, anytime
- Open system – import possible from almost all systems (ERP, industry software, CAD/CAM, Excel, CSV)  
No obligation to use specific software systems
- Simple, smart operation  
Minimal training required
- More efficient production  
Jobs completed more quickly, more safely and in higher quality



More information at  
[digital.homag.com](https://digital.homag.com)



**HOMAG Group AG**

info@homag.com  
www.homag.com

**YOUR SOLUTION**